

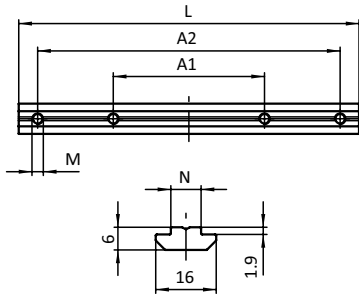

SET STRECKENVERBINDER 180, NUT 8

SET CONNECTING STRIP 180, SLOT 8

| | |
|--|---|
| Ausführung Stahl | Model Steel |
| Beschreibung zur stirnseitigen Verbindung von zwei Aluminiumprofilen ohne Profilbearbeitung | Description End-to-end connection of two aluminum profiles without machining |
| Material Stahl, verzinkt | Material Zinc plated steel |
| Set 1 Streckenverbinder 180 - Nut 8, 4 Schrauben DIN 912 - M6 × 12, 4 Scheiben DIN 7349 - 6.4 | Set 1 connecting strip 180, slot 8, 4 screws DIN 912 - M6 × 12, 4 washers DIN 7349 - 6.4 |
| Liefereinheit 10 Stück | Pack Quantity 10 pieces |



| Set Streckenverbinder 180 Set Connecting Strip 180 | A1 [mm] | A2 [mm] | L [mm] | N | Größe Size | Gewicht [g] Weight [g] | Profil Profile | Teil-Nr. Part # |
|---|------------|------------|-----------|---|---------------|---------------------------|-------------------|--------------------|
| | 80.0 | 160.0 | 180.0 | 8 | M6 | 134.0 | B | 096010S11 |

