

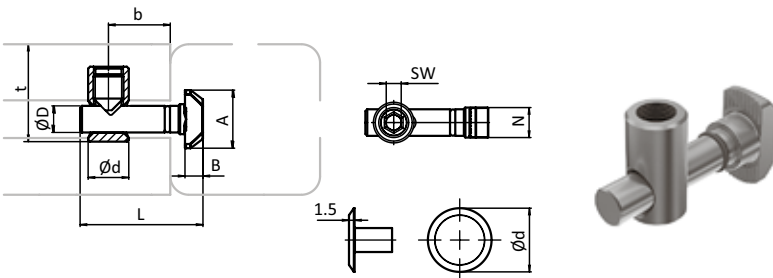

ZENTRALVERBINDER

CENTRAL CONNECTOR

| | | | |
|----------------------|--|----------------------|---|
| Ausführung | Stahl | Model | Steel |
| Beschreibung | zur rechtwinkligen Verbindung von zwei Aluminiumprofilen; zur Montage muss ein Sack- oder Durchgangsloch in eines der Profile gebohrt werden | Description | To connect two aluminum profiles at right angles; a blind or through hole must be drilled through one of the profiles to provide access to the tightening screw |
| Material | Stahl | Material | Steel |
| Liefereinheit | 10 Stück | Pack Quantity | 10 pieces |
| Hinweis | * (1) = Profil 40; (2) = Profil 45; (3) = Profil 50; (4) = Profil 60 | Tip | * (1) = profile 40; (2) = profile 45; (3) = profile 50; (4) = profile 60 |



| Winkel Angle | A [mm] | B [mm] | D [mm] | L [mm] | N | SW [mm] | Gewicht [g] Weight [g] | Profil Profile | Teil-Nr. Part # |
|--------------------------|-----------|-----------|-----------|-----------|--------------|------------|---------------------------|-------------------|--------------------|
| 0° | 15.5 | 4.8 | 7.1 | 33.0 | 8 | 4 | 21.0 | B | 099B08110700 |
| 90° | 15.5 | 4.8 | 7.1 | 33.0 | 8 | 4 | 20.0 | B | 099B08110790 |
| 0° | 19.6 | 5.5 | 7.1 | 40.0 | 8 / 10 | 4 | 26.0 | B | 099B08110700S01 |
| 90° | 19.6 | 5.5 | 7.1 | 40.0 | 8 / 10 | 4 | 26.0 | B | 099B08110790S01 |
| 0° | 19.6 | 5.5 | 9.8 | 45.5 | 10 | 6 | 56.0 | B | 099B10171000 |
| 90° | 19.6 | 5.5 | 9.8 | 45.5 | 10 | 6 | 56.0 | B | 099B10171090 |
| Abdeckkappe Cover cap | | | | | 10 *(1) *(2) | | 0.6 | B | 091107 |
| | | | | | 10 *(3) | | 0.6 | B | 091108 |

