

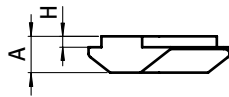

**RHOMBUSMUTTER**

**RHOMBUS NUT**

<b>Ausführung</b>	Nut 8, Zinkdruckguss	<b>Model</b>	Slot 8, zinc die-cast
<b>Beschreibung</b>	Befestigungselement für Profilmutter, leicht eindrehbar, bleibt in der Nut verschiebbar	<b>Description</b>	To fasten components to profiles, easy to insert, remains mobile in the slot
<b>Material</b>	Zinkdruckguss, blank	<b>Material</b>	Zinc die-cast, plain
<b>Liefereinheit</b>	100 Stück	<b>Pack Quantity</b>	100 pieces

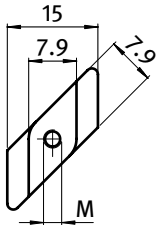

Rhombusmutter <i>Rhombus Nut</i>	A [mm]	H [mm]	Größe <i>Size</i>	Gewicht [g] <i>Weight [g]</i>	Profil <i>Profile</i>	Teil-Nr. <i>Part #</i>
	6.0	1.8	M3	4.1	B	<a href="#">096R080318Z</a>
	6.0	1.8	M4	4.0	B	<a href="#">096R080418Z</a>
	6.0	1.8	M5	3.9	B	<a href="#">096R080518Z</a>
	7.7	3.0	M3	5.1	I	<a href="#">096R080330Z</a>
	7.7	3.0	M4	5.0	I	<a href="#">096R080430Z</a>
	7.7	3.0	M5	4.9	I	<a href="#">096R080530Z</a>

