



**TELLER FÜR GELENKSTELLFÜßE, KUGEL 15**

**BASE FOR SWIVEL FEET, BALL JOINT 15**

<p><b>Ausführung</b> Kunststoff PA, mit Anschraubbohrungen</p> <p><b>Beschreibung</b> schwenkbarer, nivellierbarer Stellfuß zur Befestigung am Boden</p> <p><b>Material</b> Kunststoff PA, glaskugelverstärkt</p> <p><b>Farbe</b> schwarz</p> <p><b>Liefereinheit</b> 10 Stück</p> <p><b>Extras</b>  elektrostatisch entladend, weitere Größen, weitere Farben, angeschraubte oder geklebte Anti-Slip-Platte auf Anfrage; als montierter Stellfuß auf Anfrage</p> <p><b>Hinweis</b> passende Gewindestange siehe Seite 29 f. und Seite 31 f., passende Mutter siehe Seite 80 und Seite 81, passende Anti-Slip Platte siehe Seite 41; * Anschraubbohrung geschlossen</p>	<p><b>Model</b> Plastic PA, with bolt-down holes</p> <p><b>Description</b> A swiveling leveling foot which can be fixed to the floor</p> <p><b>Material</b> Plastic PA, glass ball reinforced</p> <p><b>Color</b> Black</p> <p><b>Pack Quantity</b> 10 pieces</p> <p><b>Specials</b>  electrostatically discharging, other sizes, other colors, bolt-on or glued anti-slip plate on request; as factory assembled leveling foot on request</p> <p><b>Tip</b> Compatible threaded rod see page 29 et sq. and page 31 et sq., Compatible nut see page 80 and page 81, Compatible anti-slip plate see page 41; * Bolt-down holes closed</p>
-------------------------------------------------------------------------------------------------------------------------------------------------------------------------------------------------------------------------------------------------------------------------------------------------------------------------------------------------------------------------------------------------------------------------------------------------------------------------------------------------------------------------------------------------------------------------------------------------------------------------------------------------------------------------	------------------------------------------------------------------------------------------------------------------------------------------------------------------------------------------------------------------------------------------------------------------------------------------------------------------------------------------------------------------------------------------------------------------------------------------------------------------------------------------------------------------------------------------------------------------------------------------------------------------------------------------

F1 (M6 - M16; UNC 1/4" - UNC 1/2")  
 F2 (M20 - M30; UNC 5/8" - UNC 2 1/4")  
 F3 (UNC 1" - UNC 1 1/4")

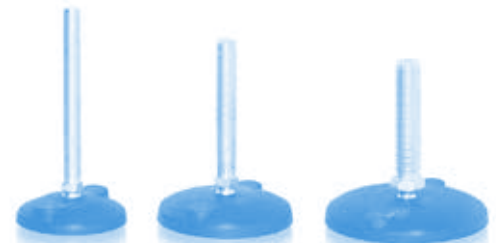
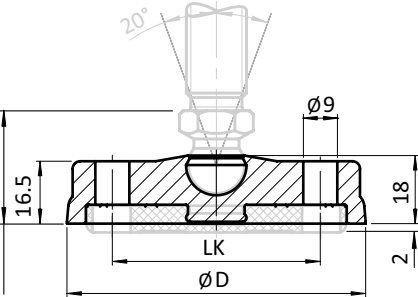

Teller Base	Teller für Gelenkstellfüße, Kugel 15 Base for Swivel Feet, Ball Joint 15	D [mm]	F1 [mm]	F2 [mm]	F3 [mm]	LK [mm]	Tragkraft [kg] Max. Load [kg]	Gewicht [g] Weight [g]	Teil-Nr. Part #
80	ohne Anti-Slip-Platte Without anti-slip plate	79	29.5	32.5	33.5	55	900	46.0	098D080KB
*80	ohne Anti-Slip-Platte Without anti-slip plate	79	29.5	32.5	33.5	55	900	46.0	098D080KBZ
100	ohne Anti-Slip-Platte Without anti-slip plate	99	29.5	32.5	33.5	74	900	86.0	098D100KB
*100	ohne Anti-Slip-Platte Without anti-slip plate	99	29.5	32.5	33.5	74	900	86.0	098D100KBZ
120	ohne Anti-Slip-Platte Without anti-slip plate	119	29.5	32.5	33.5	94	900	104.0	098D120KB
*120	ohne Anti-Slip-Platte Without anti-slip plate	119	29.5	32.5	33.5	94	900	104.0	098D120KBZ
80	mit Anti-Slip-Platte With anti-slip plate	79	29.5	32.5	33.5	55	900	69.0	098D080KBG
*80	mit Anti-Slip-Platte With anti-slip plate	79	29.5	32.5	33.5	55	900	69.0	098D080KBZG
100	mit Anti-Slip-Platte With anti-slip plate	99	29.5	32.5	33.5	74	900	123.0	098D100KBG
*100	mit Anti-Slip-Platte With anti-slip plate	99	29.5	32.5	33.5	74	900	123.0	098D100KBZG
120	mit Anti-Slip-Platte With anti-slip plate	119	29.5	32.5	33.5	94	900	164.0	098D120KBG
*120	mit Anti-Slip-Platte With anti-slip plate	119	29.5	32.5	33.5	94	900	164.0	098D120KBZG

