



ALUDRUCKGUSS-KOMBISCHARNIER 30

ALUMINUM DIE-CAST COMBI HINGE 30

Ausführung aushängbar

Beschreibung für Flächenelemente und Aluminiumprofile, pro Scharnierflügel je ein Steckplatz für Zentrierbolzen, Scharnierachse in Buchsensystem gelagert

Material Flügel: Aluminiumdruckguss
Achse: Edelstahl
Buchsen: PTFE
Zentrierbolzen (optional): Kunststoff PA, glasfaserverstärkt

Farbe Zentrierbolzen (optional): schwarz

Befestigung vorderseitig mit Senkschrauben M6

Liefereinheit 10 Stück

Model Detachable

Description To hinge panels or aluminum profiles, each wing with a hole for centering bolts, with bearing system for axle

Material Wings: Die-cast aluminum
Axle: Stainless steel
Bearings: PTFE
Centering bolts (optional): Plastic PA, glass fiber reinforced

Color Centering bolts (optional): Black

Fastening From the front, using M6 countersunk screws

Pack Quantity 10 pieces

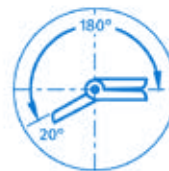
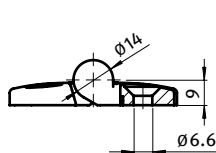
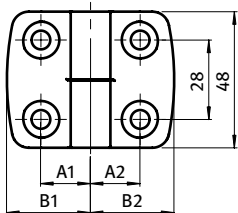

Kombischarnier Combi Hinge	A1 [mm]	A2 [mm]	B1 [mm]	B2 [mm]	F _{Amax} [N]	F _{Rmax} [N]	Bezeichnung Description	Gewicht [g] Weight [g]	Teil-Nr. Part #
L: links <i>Left</i>	17.5	17.5	29.5	29.5	280	450	30/30	64.0	095A3030LS20
	17.5	15.0	29.5	26.0	250	410	30/25	60.0	095A3025LS20
	17.5	20.0	29.5	36.0	250	500	30/35	68.0	095A3035LS20
	17.5	22.5	29.5	38.5	200	550	30/40	66.0	095A3040LS20
	17.5	25.0	29.5	43.5	200	550	30/45	68.0	095A3045LS20
	17.5	27.5	29.5	48.5	175	575	30/50	71.0	095A3050LS20
	17.5	32.5	29.5	57.5	150	575	30/60	76.0	095A3060LS20
R: rechts <i>Right</i>	17.5	17.5	29.5	29.5	280	450	30/30	64.0	095A3030RS20
	15.0	17.5	26.0	29.5	250	410	30/25	60.0	095A3025RS20
	20.0	17.5	36.0	29.5	250	500	30/35	68.0	095A3035RS20
	22.5	17.5	38.5	29.5	200	550	30/40	66.0	095A3040RS20
	25.0	17.5	43.5	29.5	200	550	30/45	68.0	095A3045RS20
	27.5	17.5	48.5	29.5	175	575	30/50	71.0	095A3050RS20
	32.5	17.5	57.5	29.5	150	575	30/60	76.0	095A3060RS20
Zentrierbolzen Centering bolt							Nut 5 Slot 5	1.0	095AN05
							Nut 6 Slot 6	1.0	095AN06
							Nut 8 Slot 8	1.0	095AN08
							Nut 10 Slot 10	1.0	095AN10
							Nut 12 Slot 12	1.0	095AN12
							Nut 14 Slot 14	1.0	095AN14

