



## KUNSTSTOFF-KOMBISCHARNIER 25

## PLASTIC COMBI HINGE 25

**Ausführung** aushängbar

**Beschreibung** für Flächenelemente und Aluminiumprofile

**Material** Flügel: Kunststoff PA, glasfaserverstärkt  
Achse: Edelstahl

**Befestigung** vorderseitig mit Senkschrauben M6

**Liefereinheit** 10 Stück

**Extras** elektrostatisch entladend, weitere Farben, Führungsnasen zur Montage auf Aluminiumprofilen auf Anfrage

**Model** Detachable

**Description** To hinge panels or aluminum profiles

**Material** Wings: Plastic PA, glass fiber reinforced  
Axle: Stainless steel

**Fastening** From the front, using M6 countersunk screws

**Pack Quantity** 10 pieces

**Specials** electrostatically discharging, further colors, fixing pins for installation on aluminum profiles available on request

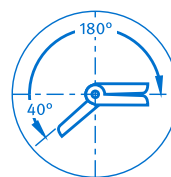
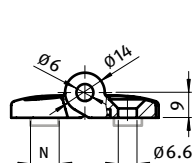
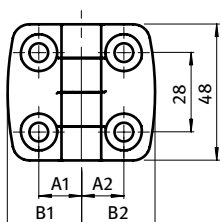

Kombischarnier Combi Hinge	A1 [mm]	A2 [mm]	B1 [mm]	B2 [mm]	F <sub>Amax</sub> [N]	F <sub>Rmax</sub> [N]	N	Bezeichnung Description	Gewicht [g] Weight [g]	Teil-Nr. Part #
L: links <i>Left</i>	15.0	15.0	26.0	26.0	425	625		25/25	31.0	095K2525L00
	15.0	15.0	26.0	26.0	425	625	6	25/25	31.0	095K2525L06
	15.0	15.0	26.0	26.0	425	625	8	25/25	31.0	095K2525L08
	15.0	17.5	26.0	29.5	500	700		25/30	33.0	095K2530L00
	15.0	20.0	26.0	36.0	400	700		25/35	35.0	095K2535L00
	15.0	22.5	26.0	38.5	350	800		25/40	37.0	095K2540L00
	15.0	25.0	26.0	43.5	325	800		25/45	38.0	095K2545L00
	15.0	27.5	26.0	48.5	320	800		25/50	40.0	095K2550L00
	15.0	32.5	26.0	57.5	240	800		25/60	43.0	095K2560L00
R: rechts <i>Right</i>	15.0	15.0	26.0	26.0	425	625		25/25	31.0	095K2525R00
	15.0	15.0	26.0	26.0	425	625	6	25/25	31.0	095K2525R06
	15.0	15.0	26.0	26.0	425	625	8	25/25	31.0	095K2525R08
	17.5	15.0	29.5	26.0	500	700		25/30	33.0	095K2530R00
	20.0	15.0	36.0	26.0	400	700		25/35	35.0	095K2535R00
	22.5	15.0	38.5	26.0	350	800		25/40	37.0	095K2540R00
	25.0	15.0	43.5	26.0	325	800		25/45	38.0	095K2545R00
	27.5	15.0	48.5	26.0	320	800		25/50	40.0	095K2550R00
	32.5	15.0	57.5	26.0	240	800		25/60	43.0	095K2560R00

